

### PRODUCT ADVANTAGES



FIRE RATED



RADIANT HEAT



LOAD BEARING



NON-SLIP SURFACE

- ▶ Fire resistive restrained glass floor assembly that allows daylight to penetrate further into the building while meeting fire rated requirements.
- ▶ Single glass unit comprised of custom SuperLite II-XL combined with a tempered laminated walking surface and a structural steel framing grid. Both the glass unit and structural steel framing grid are manufactured and provided by SAFTI *FIRST*.
- ▶ Largest tested and listed individual glass panel sizes for 60 and 120 minute floor applications.
- ▶ Meets ASTM E-119/ UL 263/ ULC-S101 and blocks smoke, flames and radiant heat up to two hours.
- ▶ Available with a durable, non-slip walking surface with loads up to 100 psf.
- ▶ Modular system with a top-loaded design for easy installation.
- ▶ Can be used in interior and exterior applications.
- ▶ Available in multiple frame finishes and glass make-ups.

#### Individual Panel Sizes:

Fire Rating	Application	Max. Area	Max. Width	Max. Height
60 minutes	Fully Supported	7,017.3 sq. in.	82-3/8 in.	85-3/16 in.
60 minutes	Butt-glazed	4,763.9 sq. in.	67-7/8 in.	70-3/16 in.
120 minutes	Fully Supported	5,889.6 sq. in.	78 in.	78 in.
120 minutes	Butt-glazed	3,700.8 sq. in.	78 in.	78 in.

### UL AND INTERTEK TESTED AND CERTIFIED



GPX FireFloor System is listed and labeled by Intertek and Underwriters Laboratories, nationally recognized testing laboratories approved by OSHA.

### FIRE RESISTIVE

Meets standard code for floor loading.

Contains smoke, flames and blocks the passage of radiant heat.

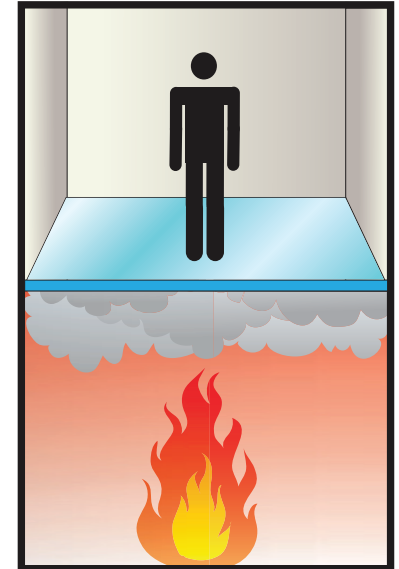

### SPECIFICATIONS

**Thickness:** 4-3/16 in. for 60 minute.  
5-3/16" thick for 120 minute.

**Weight:** Approx. 40 lbs./sq. ft. for 60 minute.  
51.6 lbs. per square foot for 120 minute.

**Fire Rating:** 60-120 minutes. Meets ASTM E-119, UL 263 and ULC-S101.

**Load:** Up to 100 psf.

### APPROVALS

ASTM E-119, UL 263 and ULC-S101.

#### 3-Part Specifications:

Available at

[www.safti.com/specifications](http://www.safti.com/specifications)



Made in the USA

### TYPICAL DETAILS More details available at [www.safti.com/details](http://www.safti.com/details)

#### 60 minute GPX FireFloor System

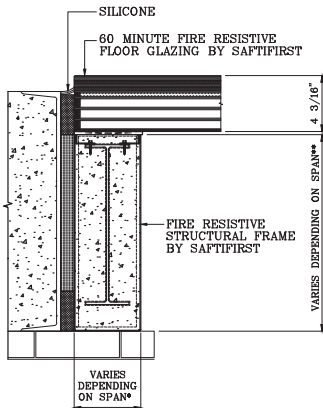

1 JAMB AT CONCRETE OPENING

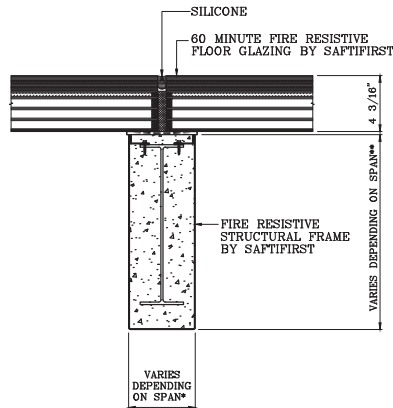

2 BEAM DETAIL

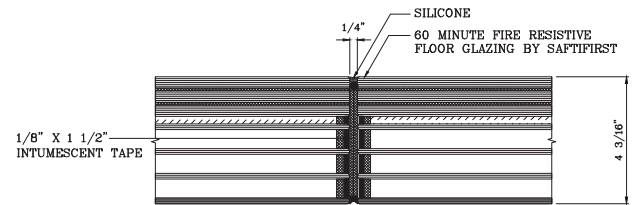

5 BUTT GLAZED DETAIL

#### 120 minute GPX FireFloor System

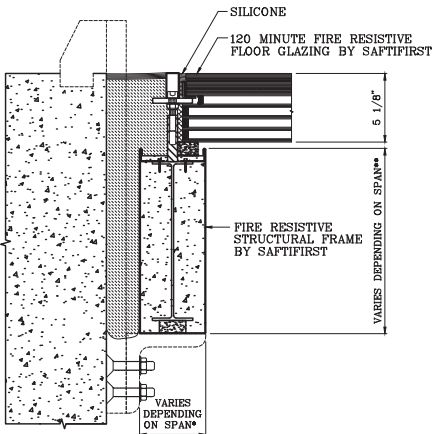

1 JAMB AT CONCRETE OPENING

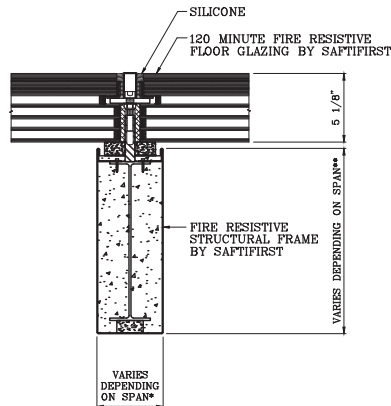

2 BEAM DETAIL

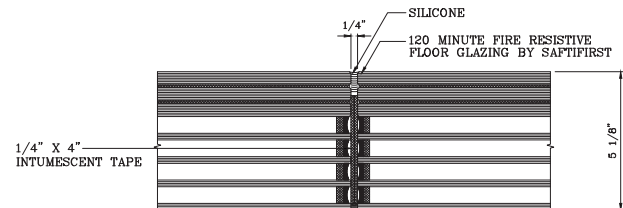

5 BUTT GLAZED DETAIL

\*Span table and loading criteria available by downloading the 3-part specifications at [www.safti.com/specifications](http://www.safti.com/specifications).

The information provided herein is for general reference only and is subject to change without notice. Please visit [www.safti.com](http://www.safti.com) for the most updated information. © SAFTI FIRST April 2018