

PRODUCT ADVANTAGES

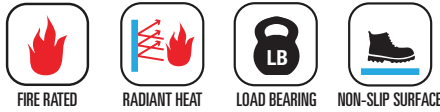

- ▶ Fire resistive restrained glass floor assembly that allows daylight to penetrate further into the building while meeting fire rated requirements.
- ▶ Single glass unit comprised of custom SuperLite II-XL combined with a tempered laminated walking surface and a structural steel framing grid. Both the glass unit and structural steel framing grid are manufactured and provided by SAFTI FIRST.
- ▶ Largest tested and listed individual glass panel sizes for 60 and 120 minute floor applications.
- ▶ Meets ASTM E-119/ UL 263/ ULC-S101 and blocks smoke, flames and radiant heat up to two hours.
- ▶ Available with a durable, non-slip walking surface with loads up to 100 psf.
- ▶ Modular system with a top-loaded design for easy installation.
- ▶ Can be used in interior and exterior applications.
- ▶ Available in multiple frame finishes and glass make-ups.

Individual Panel Sizes:

Fire Rating	Application	Max. Area	Max. Width	Max. Length
60 minutes	Fully Supported	7,017.3 sq. in.	82-3/8 in.	85-3/16 in.
60 minutes	Butt-glazed	4,763.9 sq. in.	67-7/8 in.	70-3/16 in.
120 minutes	Fully Supported	7,179.9 sq. in.	96-3/8 in.	74-1/2 in.
120 minutes	Butt-glazed	7,179.9 sq. in.	96-3/8 in.	74-1/2 in.

UL AND INTERTEK TESTED AND CERTIFIED



GPX FireFloor System is listed and labeled by Intertek and Underwriters Laboratories, nationally recognized testing laboratories approved by OSHA.

FIRE RESISTIVE

Meets standard code for floor loading.
Contains smoke, flames and blocks the passage of radiant heat.

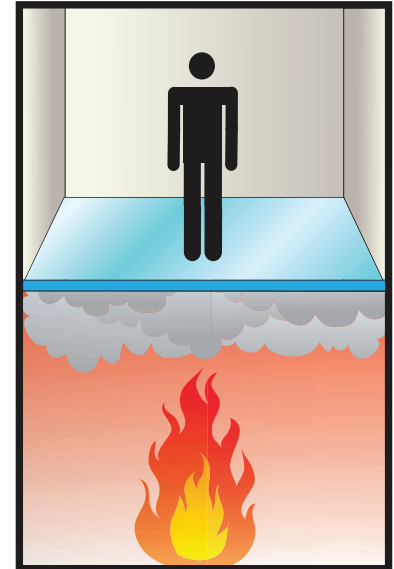

SPECIFICATIONS

Thickness: 4-3/16 in. for 60 minute.
5-3/8" thick for 120 minute.

Weight: Approx. 40 lbs./sq. ft. for 60 minute.
51.6 lbs. per square foot for 120 minute.

Fire Rating: 60-120 minutes. Meets ASTM E-119, UL 263 and ULC-S101.

Load: Up to 100 psf.

APPROVALS

ASTM E-119, UL 263 and ULC-S101.

3-Part Specifications:

Available at

www.safti.com/specifications



Made in the USA

TYPICAL DETAILS More details available at www.safti.com/details

60 minute GPX FireFloor System

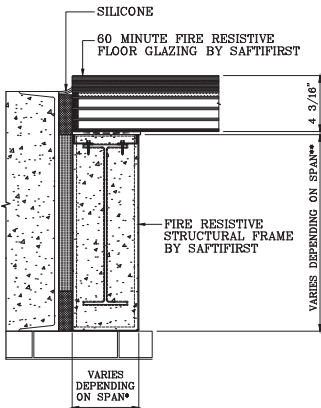

1 JAMB AT CONCRETE OPENING

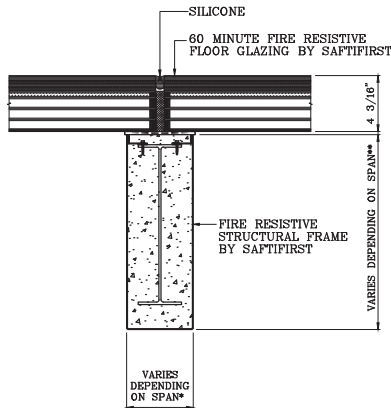

2 BEAM DETAIL

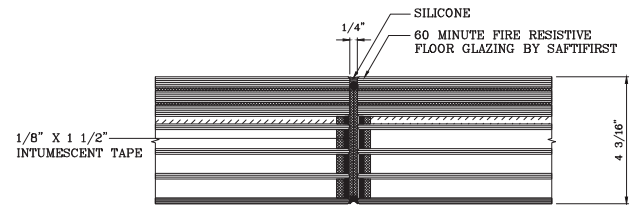

5 BUTT GLAZED DETAIL

120 minute GPX FireFloor System

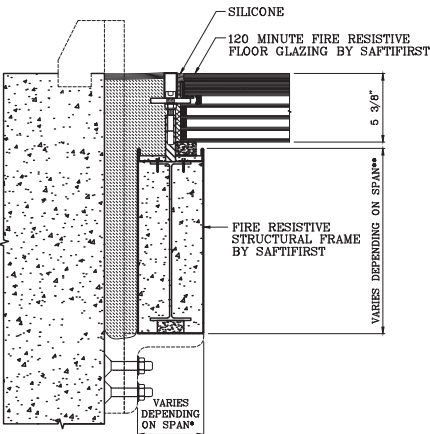

1 JAMB AT CONCRETE OPENING

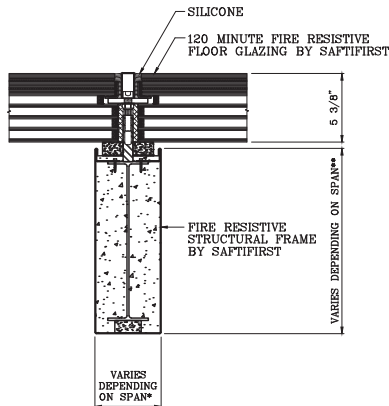

2 BEAM DETAIL

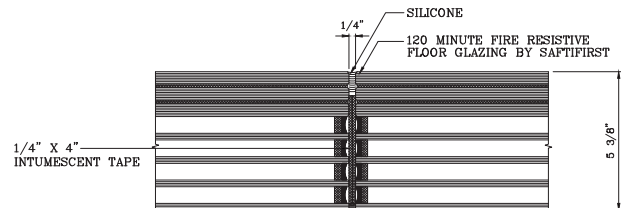

5 BUTT GLAZED DETAIL

*Span table and loading criteria available by downloading the 3-part specifications at www.safti.com/specifications.

The information provided herein is for general reference only and is subject to change without notice. Please visit www.safti.com for the most updated information. © SAFTI FIRST July 2018