

### PRODUCT ADVANTAGES



FIRE RATED



RADIANT HEAT



LOAD BEARING

- ▶ Fire resistive restrained glass floor assembly that allows daylight to penetrate further into the building while meeting fire rated requirements.
- ▶ Single glass unit comprised of custom SuperLite II-XL combined with a tempered laminated walking surface and a structural steel framing grid. Both the glass unit and structural steel framing grid are manufactured and provided by SAFTI *FIRST*.
- ▶ Designed with no airspace between the fire rated glass and walkable surface to eliminate condensation issues.
- ▶ Largest tested and listed individual glass panel sizes at 82-3/8" x 85-3/16" fully supported and 67-7/8" x 70-3/16" butt-glazed.
- ▶ Meets ASTM E-119 and blocks smoke, flames and radiant heat up to one hour.
- ▶ Available with a durable, non-slip walking surface with loads up to 100 psf.
- ▶ Modular system with a top-loaded design for easy installation.
- ▶ Can be used in interior and exterior applications.
- ▶ Available in multiple frame finishes and glass make-ups.

### INTERTEK/WHI TESTED AND CERTIFIED



GPX Architectural Series is listed and labeled by Intertek/Warnock-Hersey Inc., a nationally recognized testing laboratory approved by OSHA.

### APPROVALS

ASTM E-119, UL 263 and NFPA 251.

### FIRE RESISTIVE

Meets standard code for floor loading.

Contains smoke, flames and blocks the passage of radiant heat.

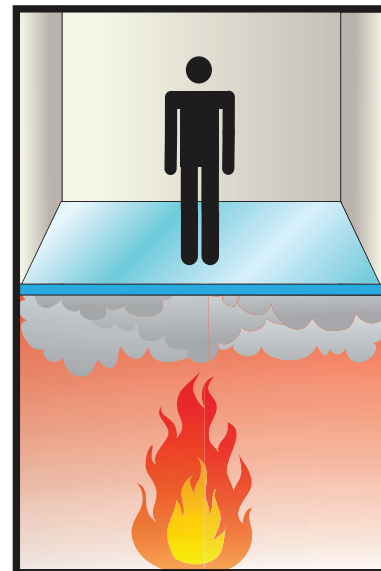

### SPECIFICATIONS

**Thickness:** 4-3/16 in.

**Weight:** Approx. 40 lbs./sq. ft.

**Individual Panel Size:** 82-3/8" x 85-3/16" fully supported and 67-7/8" x 70-3/16" butt-glazed.

**Fire Rating:** 60 minutes. Meets ASTM E-119, UL 263 and NFPA 251.

**Load:** Up to 100 psf.



**Made in the USA**

## TYPICAL DETAILS

**GPX FireFloor System - Midspan Condition**

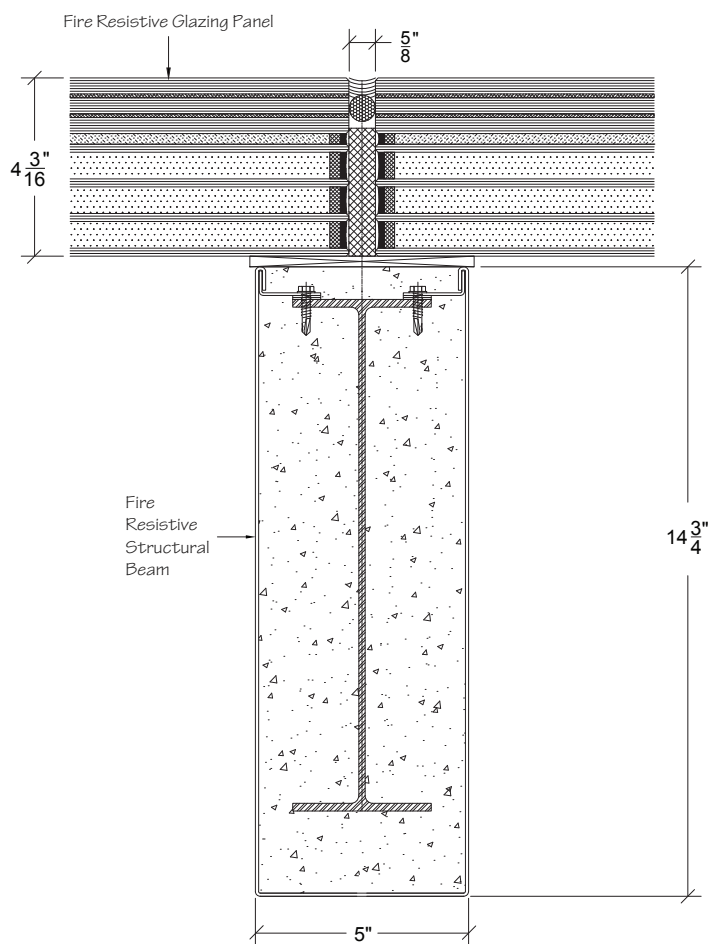

**GPX FireFloor System - Edge Condition**

