NFRC CMAST

U-Factor, SHGC & VT Simulated Values with SuperLite II-XL and GPX Framing by SAFTI **FIRST**

General Disclaimer:

The values shown here are simulations performed in CMAST using NFRC's standard test sizes. They serve as general performance indicators or predictors only. U-Factors and thermal performance are general weighted averages comprised of center of glass, glass edge and framing values, while SHGC is predicated on the coatings. Overall size, configuration and quantities may impact performance levels.

Designers may request project-specific NFRC Bid Reports using the sizes and configurations for that project. These bid reports are for design purposes only and are not official NFRC Label Certificates. If NFRC Label Certificates are needed, it may be requested and provided for a fee.

Starphire versions of SuperLite II-XL products are also available. Please note that SAFTI FIRST can only simulate U-Factors, SHGC and VT on products that are available in CMAST.

NFRC CMAST U-Factor, SHGC and VT Simulated Values

All sizes are based on NFRC standard test sizes in CMAST

Solarban 60 (2) Clear + 1/2" Air + SuperLite II-XL 45 in GPX Framing

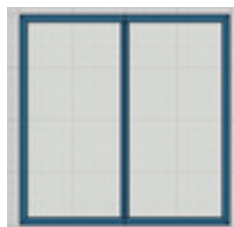
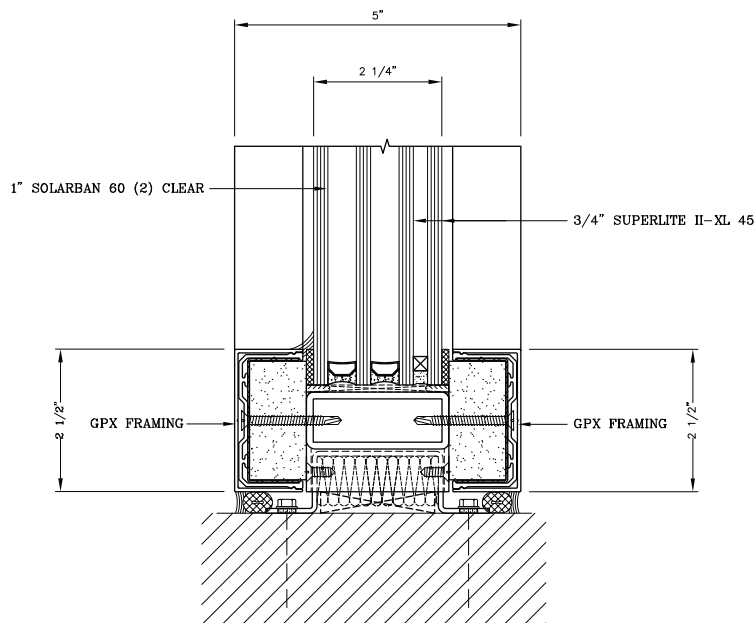

Curtain Wall with Vertical Mullions -
78.74 in. x 78.74 in.

U-Factor: 0.260

SHGC: 0.293

VT: 0.50

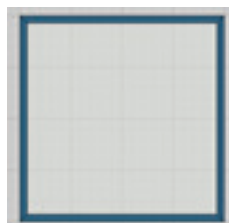

Punched Opening -
47.24 in. x 59.06 in.

U-Factor: 0.265

SHGC: 0.284

VT: 0.483

Solarban 60 (2) Clear + 1/2" Air + SuperLite II-XL 60 in GPX Framing

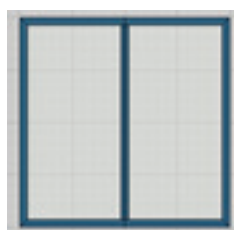
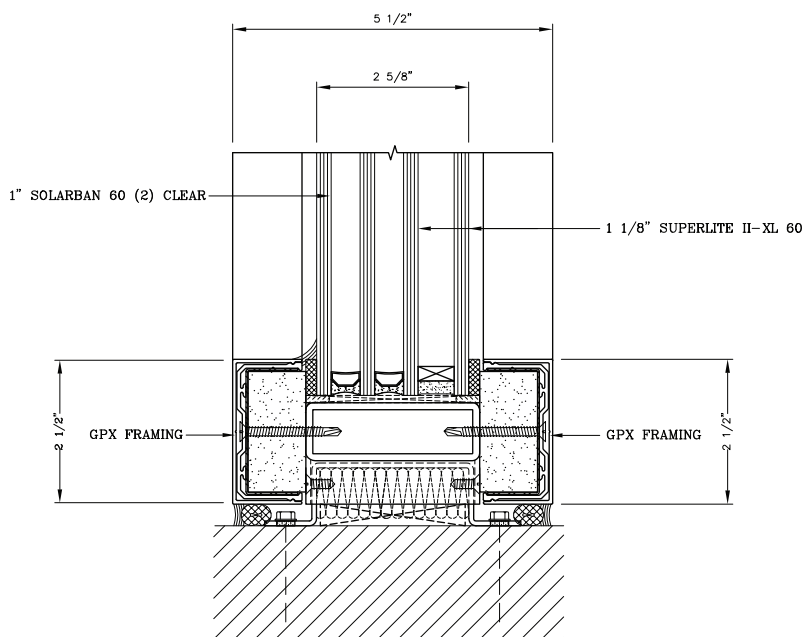

Curtain Wall with Vertical Mullions -
78.74 in. x 78.74 in.

U-Factor: 0.258

SHGC: 0.294

VT: 0.504

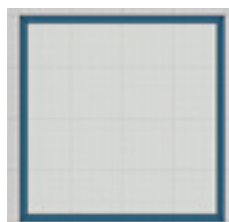

Punched Opening -
47.24 in. x 59.06 in.

U-Factor: 0.264

SHGC: 0.285

VT: 0.487

NFRC CMAST U-Factor, SHGC and VT Simulated Values

All sizes are based on NFRC standard test sizes in CMAST

Solarban 60 (2) Clear + 1/4" Air + SuperLite II-XL 120 in GPX Framing

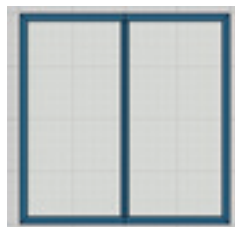
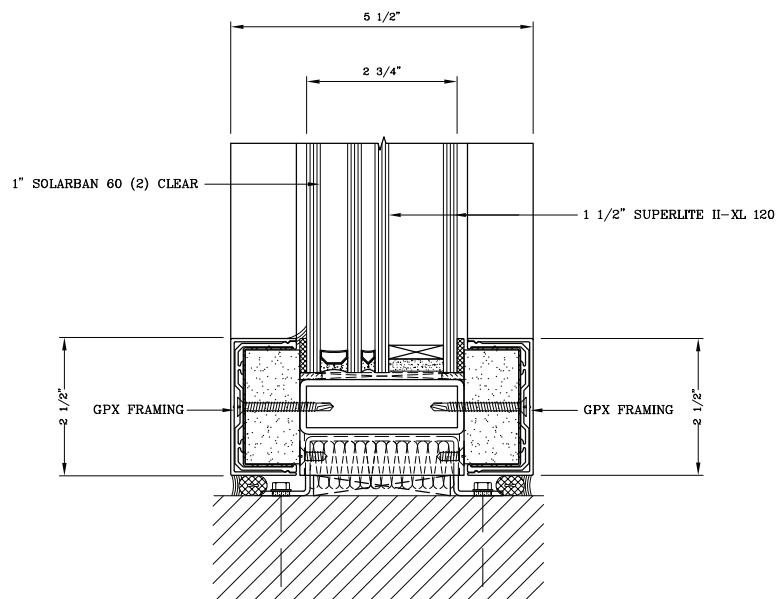

Curtain Wall with Vertical Mullions -
78.74 in. x 78.74 in.

U-Factor: 0.262

SHGC: 0.293

VT: 0.502

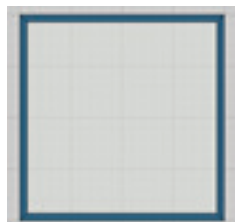

Punched Opening -
47.24 in. x 59.06 in.

U-Factor: 0.267

SHGC: 0.284

VT: 0.485

Solarban 70XL (2) Clear + 1/2" Air + SuperLite II-XL 45 in GPX Framing

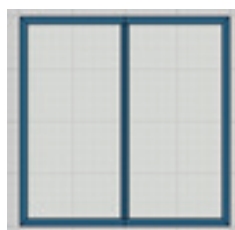
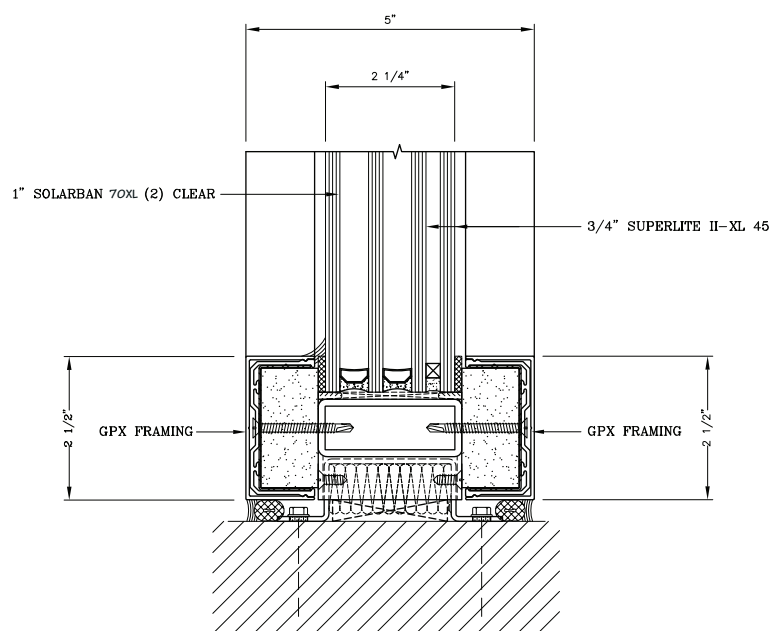

Curtain Wall with Vertical Mullions -
78.74 in. x 78.74 in.

U-Factor: 0.258

SHGC: 0.210

VT: 0.446

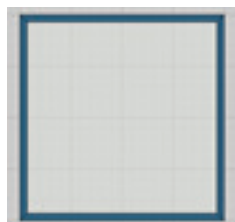

Punched Opening -
47.24 in. x 59.06 in.

U-Factor: 0.263

SHGC: 0.204

VT: 0.431

NFRC CMAST U-Factor, SHGC and VT Simulated Values

All sizes are based on NFRC standard test sizes in CMAST

Solarban 70XL (2) Clear + ½" Air + SuperLite II-XL 60 in GPX Framing

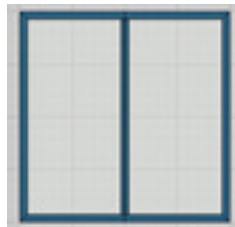
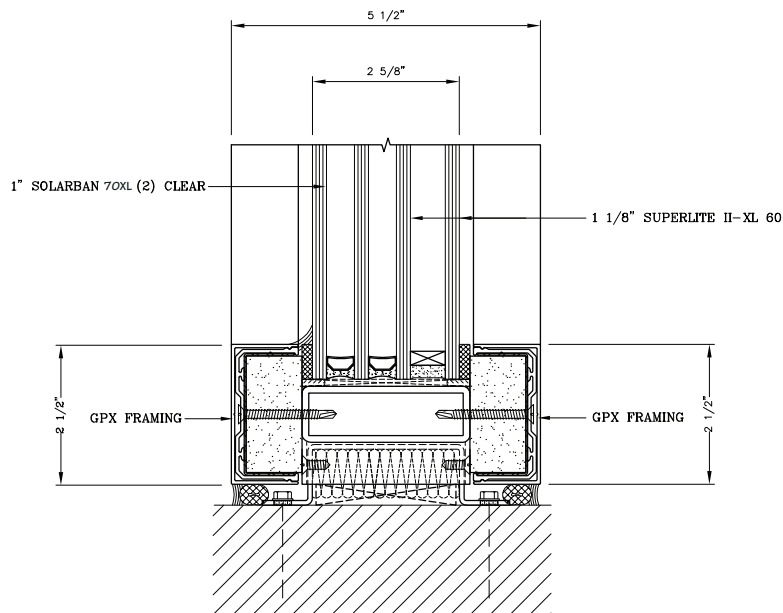

Curtain Wall with Vertical Mullions -
78.74 in. x 78.74 in.

U-Factor: 0.256

SHGC: 0.212

VT: 0.450

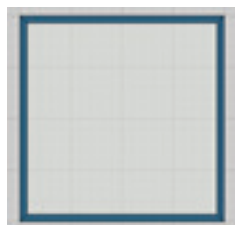

Punched Opening -
47.24 in. x 59.06 in.

U-Factor: 0.262

SHGC: 0.206

VT: 0.434

Solarban 70XL (2) Clear + ¼" Air + SuperLite II-XL 120 in GPX Framing

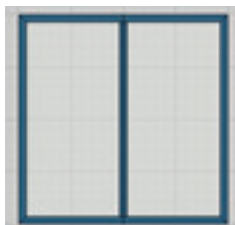
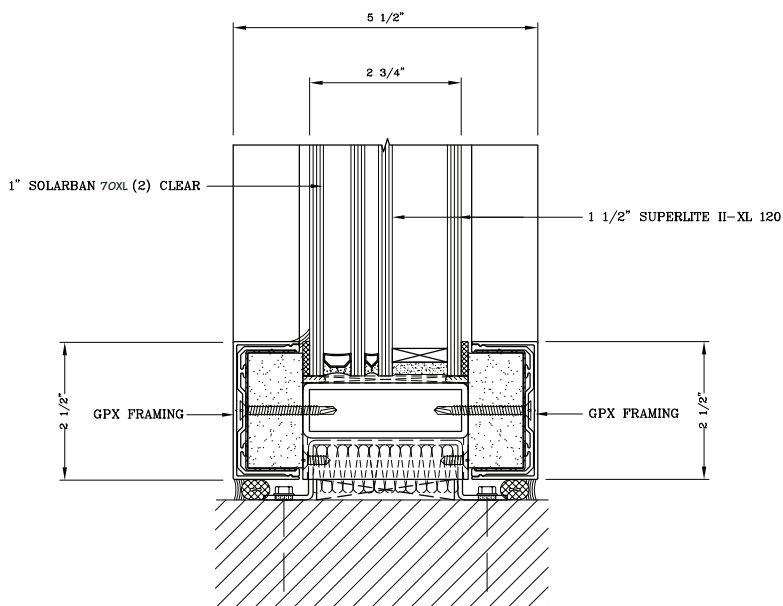

Curtain Wall with Vertical Mullions -
78.74 in. x 78.74 in.

U-Factor: 0.259

SHGC: 0.211

VT: 0.448

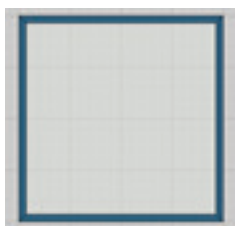

Punched Opening -
47.24 in. x 59.06 in.

U-Factor: 0.265

SHGC: 0.205

VT: 0.433

NFRC CMAST U-Factor, SHGC and VT Simulated Values

All sizes are based on NFRC standard test sizes in CMAST

1/4" Clear Tempered + 1/2" Air + SuperLite II-XL 45 in GPX Framing

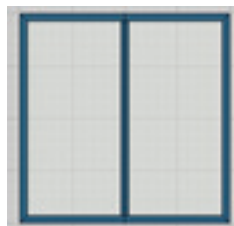
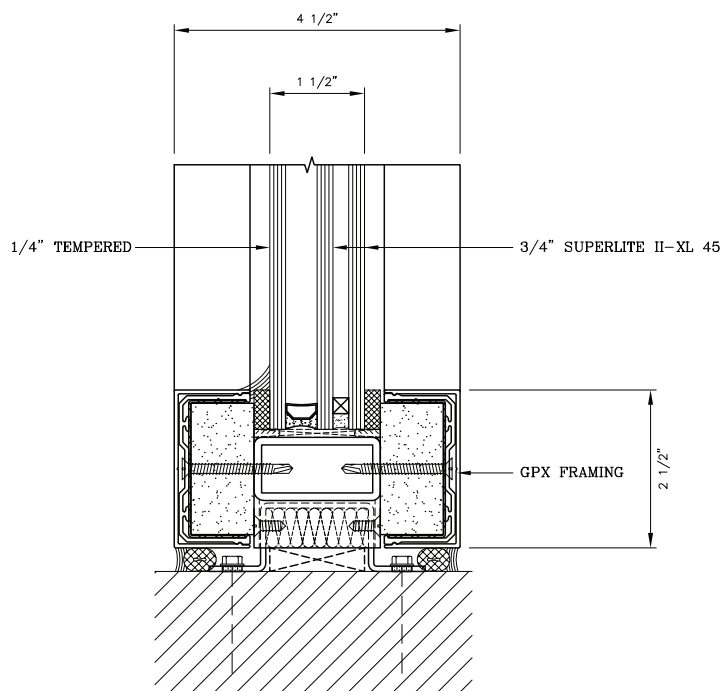

Curtain Wall with Vertical Mullions -
78.74 in. x 78.74 in.

U-Factor: 0.438

SHGC: 0.540

VT: 0.636

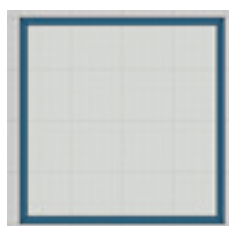

Punched Opening -
47.24 in. x 59.06 in.

U-Factor: 0.438

SHGC: 0.524

VT: 0.614

1/4" Clear Tempered + 1/2" Air + SuperLite II-XL 60 in GPX Framing

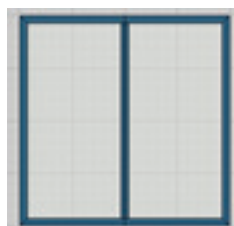
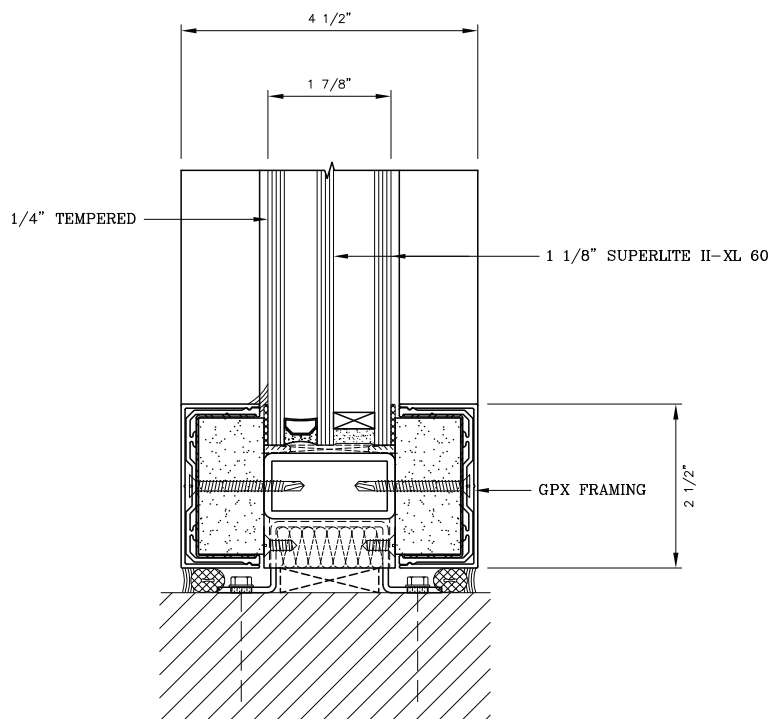

Curtain Wall with Vertical Mullions -
78.74 in. x 78.74 in.

U-Factor: 0.412

SHGC: 0.528

VT: 0.631

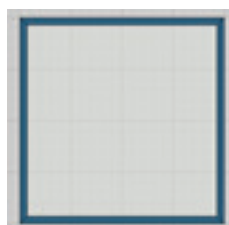

Punched Opening -
47.24 in. x 59.06 in.

U-Factor: 0.413

SHGC: 0.512

VT: 0.609

NFRC CMAST U-Factor, SHGC and VT Simulated Values

All sizes are based on NFRC standard test sizes in CMAST

1/4" Clear Tempered + 1/2" Air + SuperLite II-XL 120 in GPX Framing

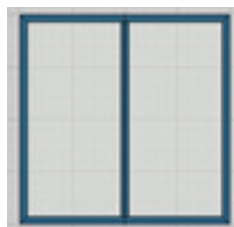
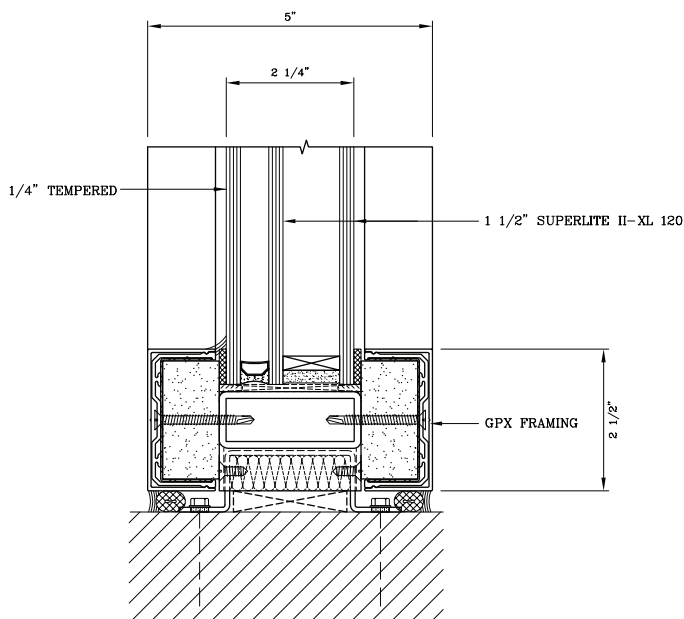

Curtain Wall with Vertical Mullions -
78.74 in. x 78.74 in.

U-Factor: 0.391

SHGC: 0.519

VT: 0.628

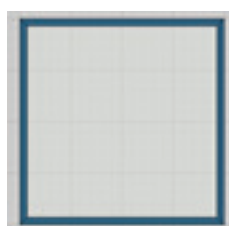

Punched Opening -
47.24 in. x 59.06 in.

U-Factor: 0.393

SHGC: 0.503

VT: 0.606

5/16" Solarban 60 Lami + 1/4" Air + SuperLite II-XL 45 in GPX Framing

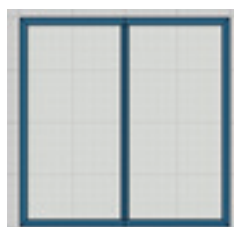
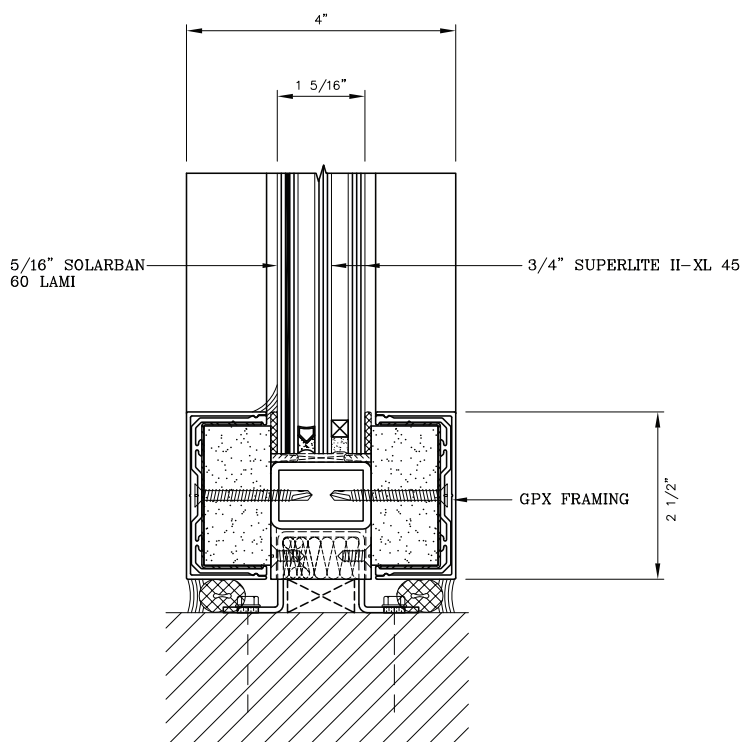

Curtain Wall with Vertical Mullions -
78.74 in. x 78.74 in.

U-Factor: 0.475

SHGC: 0.306

VT: 0.535

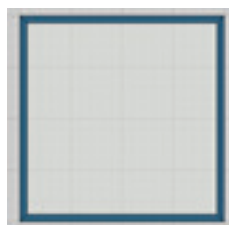

Punched Opening -
47.24 in. x 59.06 in.

U-Factor: 0.474

SHGC: 0.297

VT: 0.517

NFRC CMAST U-Factor, SHGC and VT Simulated Values

All sizes are based on NFRC standard test sizes in CMAST

5/16" Solarban 60 Lami + 1/2" Air + SuperLite II-XL 60 in GPX Framing

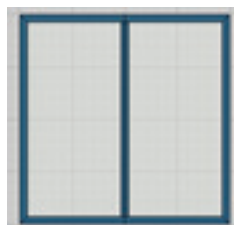
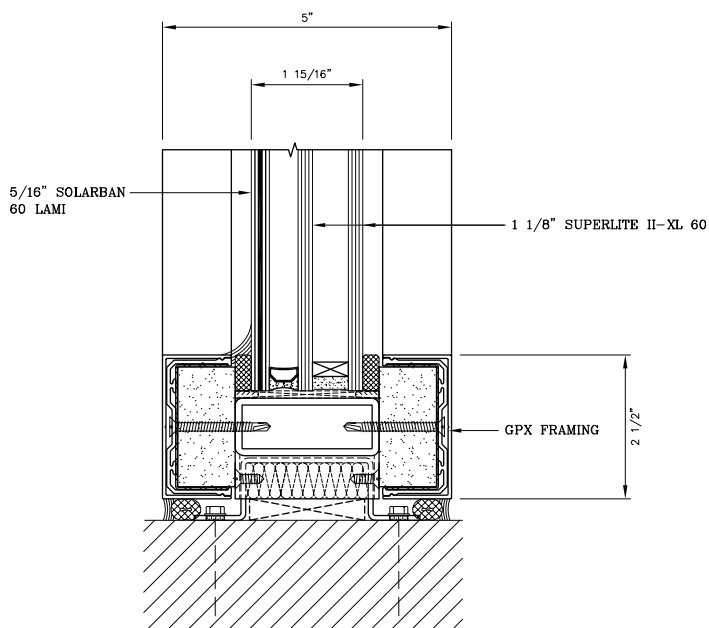

Curtain Wall with Vertical Mullions -
78.74 in. x 78.74 in.

U-Factor: 0.407
SHGC: 0.298
VT: 0.530

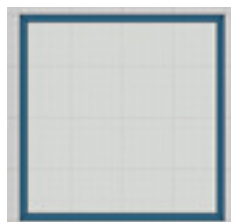

Punched Opening -
47.24 in. x 59.06 in.

U-Factor: 0.408
SHGC: 0.290
VT: 0.512

5/16" Solarban 60 Lami + 3/8" Air + SuperLite II-XL 120 in GPX Framing

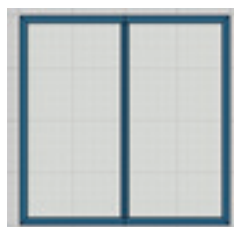
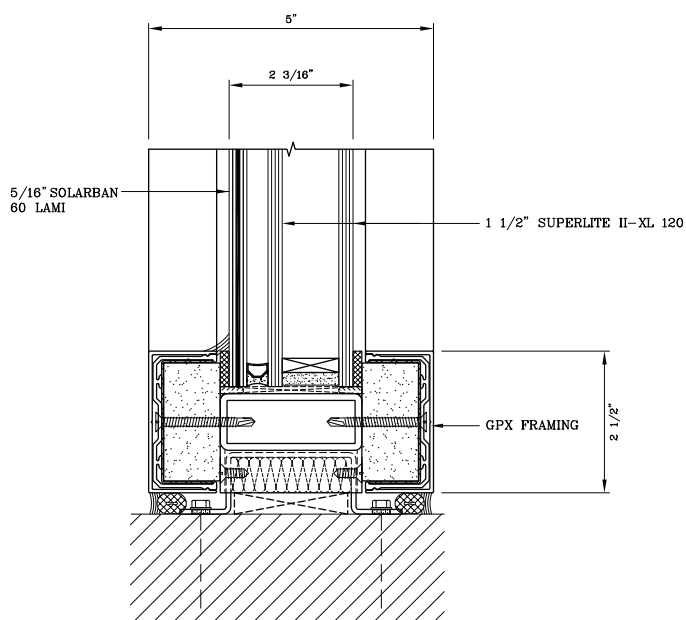

Curtain Wall with Vertical Mullions -
78.74 in. x 78.74 in.

U-Factor: 0.420
SHGC: 0.295
VT: 0.528

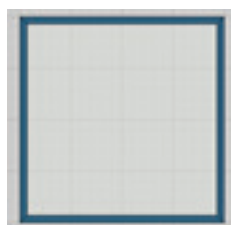

Punched Opening -
47.24 in. x 59.06 in.

U-Factor: 0.421
SHGC: 0.286
VT: 0.510

NFRC CMAST U-Factor, SHGC and VT Simulated Values

All sizes are based on NFRC standard test sizes in CMAST

1/4" Pilkington Energy Advantage Low-E + 1/2" Air + SuperLite II-XL 45 in GPX Framing

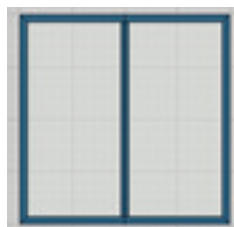
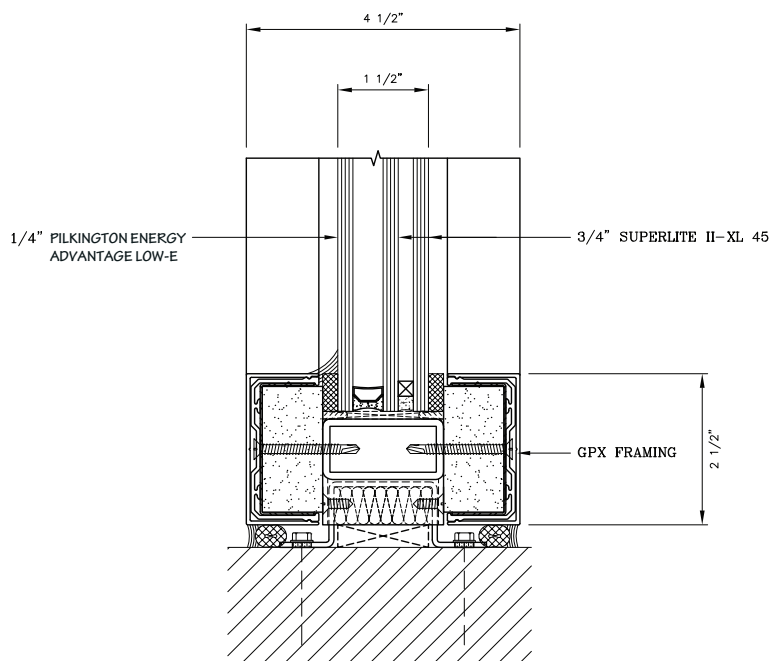

Curtain Wall with Vertical Mullions -
78.74 in. x 78.74 in.

U-Factor: 0.342

SHGC: 0.498

VT: 0.591

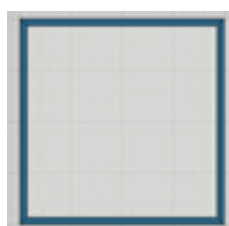

Punched Opening -
47.24 in. x 59.06 in.

U-Factor: 0.344

SHGC: 0.483

VT: 0.570

1/4" Pilkington Energy Advantage Low-E + 1/2" Air + SuperLite II-XL 60 in GPX Framing

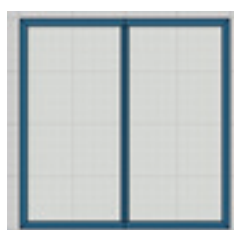
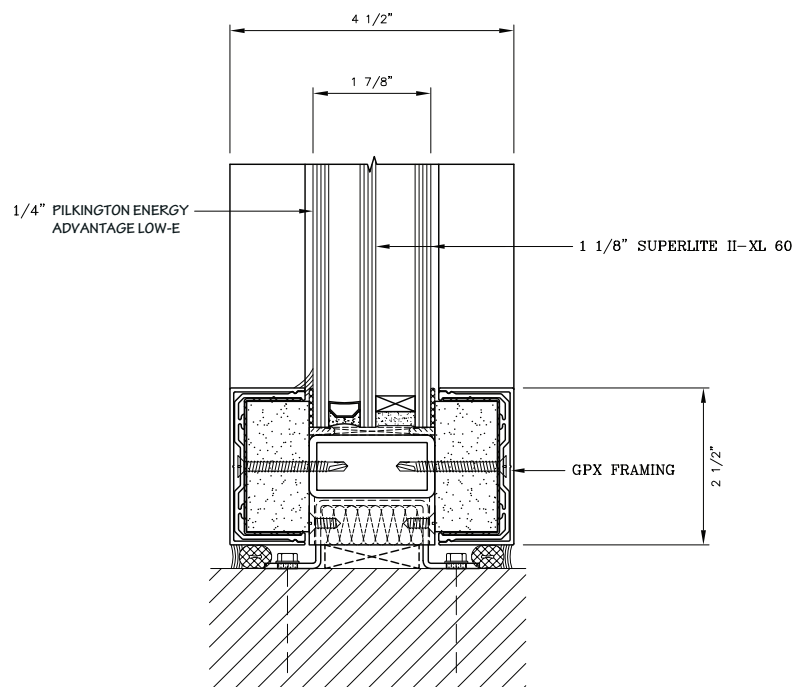

Curtain Wall with Vertical Mullions -
78.74 in. x 78.74 in.

U-Factor: 0.327

SHGC: 0.490

VT: 0.586

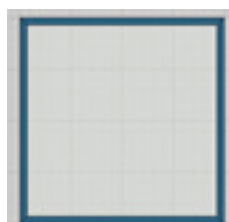

Punched Opening -
47.24 in. x 59.06 in.

U-Factor: 0.329

SHGC: 0.475

VT: 0.565

NFRC CMAST U-Factor, SHGC and VT Simulated Values

All sizes are based on NFRC standard test sizes in CMAST

1/4" Pilkington Energy Advantage Low-E + 1/2" Air + SuperLite II-XL 120 in GPX Framing

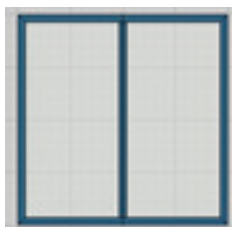
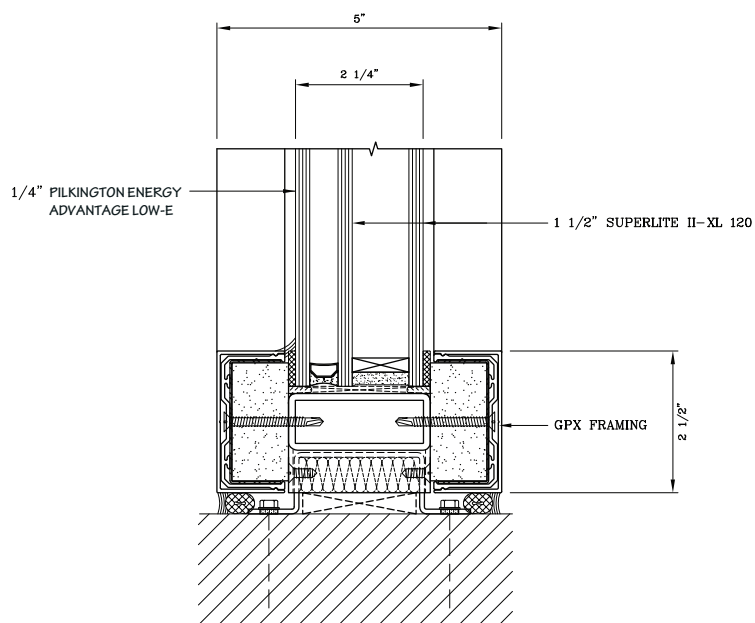

Curtain Wall with Vertical Mullions -
78.74 in. x 78.74 in.

U-Factor: 0.315

SHGC: 0.482

VT: 0.583

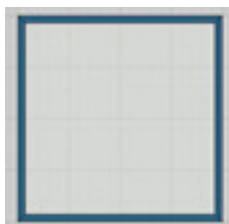

Punched Opening -
47.24 in. x 59.06 in.

U-Factor: 0.319

SHGC: 0.467

VT: 0.563