

# SuperLite™ II-XL 120

120 Minute  
Fire Resistive Glazing

## PRODUCT ADVANTAGES



- ▶ Maximum fire and impact safety with hose stream and full radiant heat protection.
- ▶ Largest tested and approved sizes up to 4,876 in.<sup>2</sup> (3.15 m<sup>2</sup>) in standard 1-1/2 in. (38 mm) profile.
- ▶ Tint-free and optically clear. Perfect for property line requirements.
- ▶ Acoustical value of 44 STC.
- ▶ Available in custom architectural make-ups, such as laminated glass and energy-saving insulated units with NFRC certifications when used with GPX Framing.
- ▶ 5 year manufacturer's warranty.
- ▶ USA manufactured for fast lead times and competitive pricing.



Now available with Starphire® Ultra-Clear Glass by PPG

### Largest Sizes for Sidelites, Windows, Transoms and Walls

Fire Rating	Max. CV Area	Max. CV Width	Max. CV Height	Stops
All 120 minute applications	4,876 in. <sup>2</sup> (3.15 m <sup>2</sup> )	124 in. (3.15 m)	124 in. (3.15 m)	5/8 in. (16 mm)

1 in. stops recommended (25 mm)

## UL AND INTERTEK/WHI TESTED AND CERTIFIED



SuperLite II-XL is listed and labeled by Intertek/Warnock-Hersey Inc. and Underwriters Laboratories, nationally recognized testing laboratories approved by OSHA.

## APPROVALS

UL 9, UL 10B, UL 10C, UL 263, NFPA 80, NFPA 251, NFPA 252, NFPA 257, ASTM E119, ASTM E152, ASTM E163, ASTM E2074, ASTM E2010-01, CPSC 16 CFR 1201 Cat. II, ULC CAN4-S101, ULC CAN4-S104, ULC CAN4-S106, NFRC 100, NFRC 200, NFRC 500.

## FIRE RESISTIVE

Contains smoke, flames and blocks the passage of radiant heat.

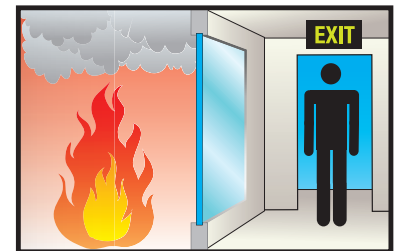

## SPECIFICATIONS

**Thickness:** 1-1/2 in. (38 mm) standard thickness;  
2-1/4 in. (57 mm) when insulated with Low-E

**Weight:** 12 lbs./sq. ft. (59 kg/m<sup>2</sup>)  
in 1-1/2 in. (38 mm) standard profile

**Sound Transmission Rating:** STC 44  
rating in 1-1/2 in. (38 mm) standard profile

**Fire Rating:** 120 minutes with hose stream  
Meets ASTM E119 and NFPA 251

**Impact Safety Rating:**  
CPSC 16 CFR 1201 Cat. I and II

**NFRC Certifications with GPX Framing:**  
0.34 U-Factor when insulated with Solarban 60

0.27 SHGC when insulated with Solarban 60

55 Condensation Resistance when insulated with Solarban 60

### 3-Part Specifications:

Available at

[www.safti.com/specifications](http://www.safti.com/specifications)



Made in the USA

[www.safti.com](http://www.safti.com)

**SAFTIFIRST™**  
SINCE 1981

888.653.3333

# SuperLite™ II-XL 120

**120 Minute  
Fire Resistive Glazing**



Project: Reece School in New York, NY  
Architect: Platt Byard Dovell White Architects LLP  
Glazier: Industrial Window Corporation



Project: CA Endowment Building in Los Angeles, CA  
Architect: House and Robertson Architects  
Glazier: Benson Industries, Inc.

Here are two examples of how GPX Framing with SuperLite II-XL glazing enhances interior spaces with elegant transparency during normal use, while protecting building occupants from the danger of radiant heat and providing safe egress during a fire.

## TYPICAL DETAILS *More details available at [www.safti.com/details](http://www.safti.com/details)*

### SuperLite II-XL 120 in GPX Framing and SuperLite II-XL 90 in GPX Door

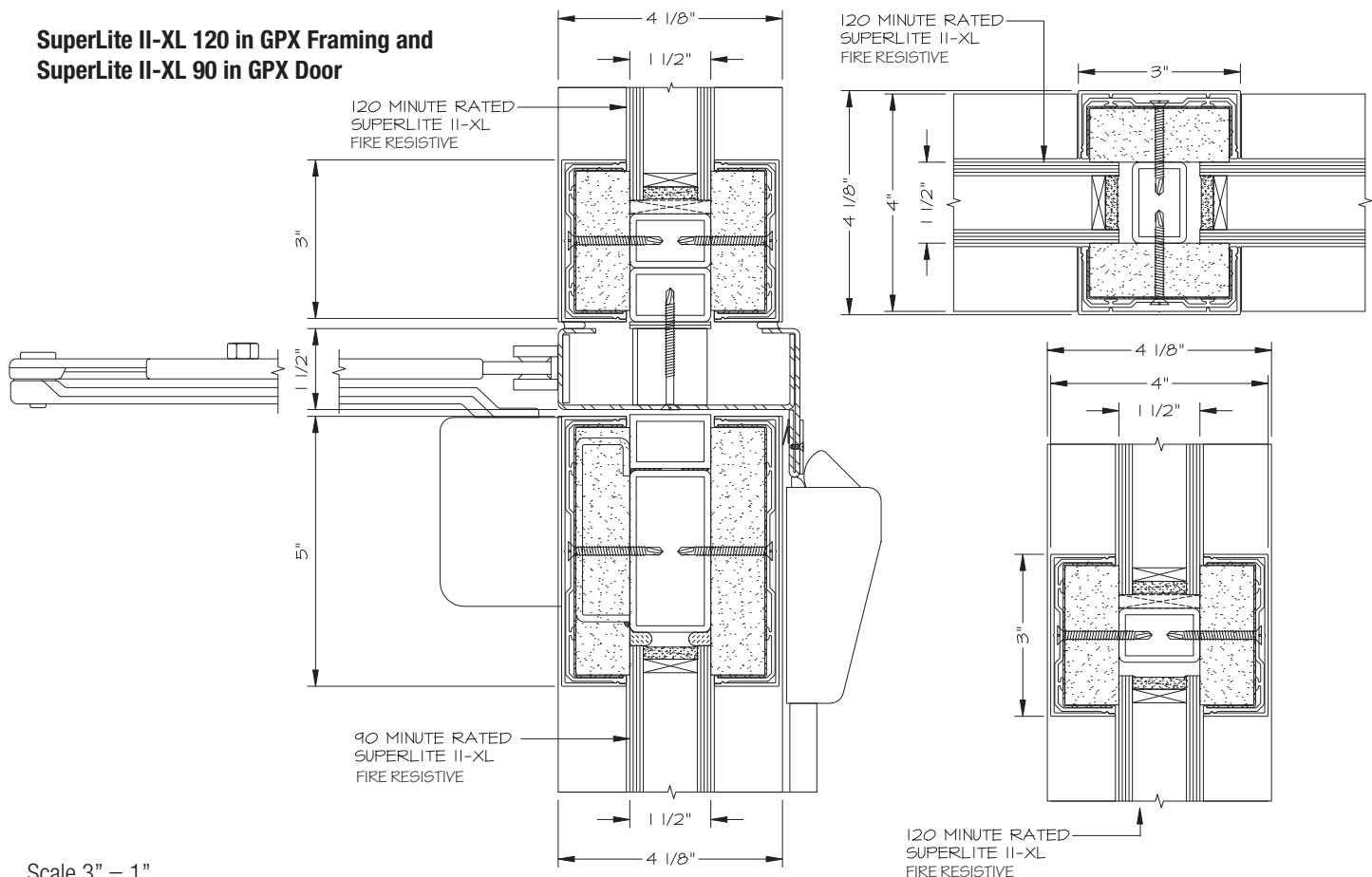

Scale 3" = 1"

The information provided herein is for general reference only. Please visit [www.safti.com](http://www.safti.com) for the most updated information. © SAFTI FIRST June 2014