

SPECIFICATIONS



FIRE RATED



HOSE STREAM



IMPACT RATED



THERMAL SHOCK



POSITIVE PRESSURE



GREEN

Material: 20 gauge steel.

Construction: 2" trim, mitered and welded.
Continuous glass retainer, mounting holes in the bevel on non-corridor side.

Fasteners: #8 x 32 – 1-1/2" panhead philips.

Finishes: Primed for field paint or Corafion finishes by PPG. Custom finishes available upon request (check with SAFTI FIRST).

Glass: Can be used with SuperLite I, SuperClear 45-HS, SuperClear 45-HS-LI, SuperLite X-45/60/90, SuperLite II-XL 45, SuperLite II-XL 60 and SuperLite II-XL 90.

Please include door cut out size when requesting a quote or placing your order.

UL TESTED AND CERTIFIED



GPX Vision Kit is listed and labeled by Underwriters Laboratories, a nationally recognized testing laboratory approved by OSHA.



Made in the USA

TYPICAL DETAILS

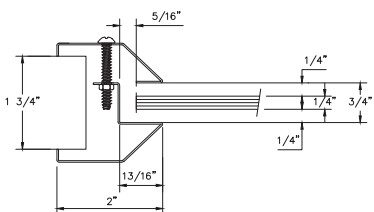

SuperLite I or SuperLite I-XL

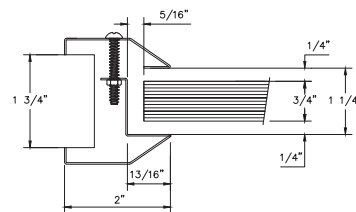
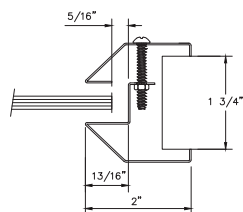

SuperClear 45-HS or SuperClear 45-HS-LI

TYPICAL DETAILS

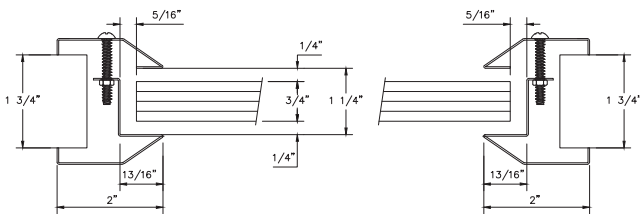

SuperLite X-45/60/90

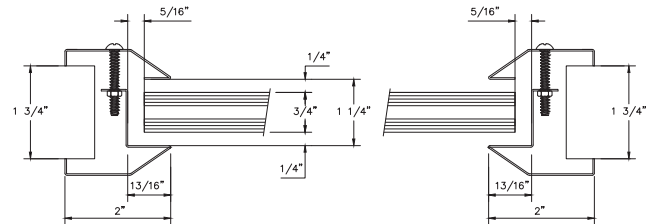

SuperLite II-XL 45

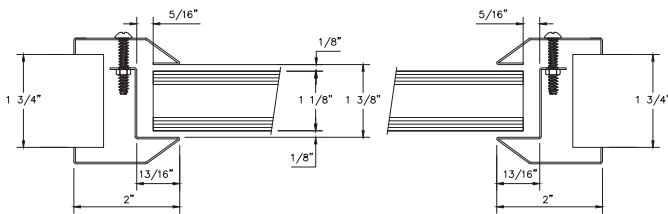

SuperLite II-XL 60

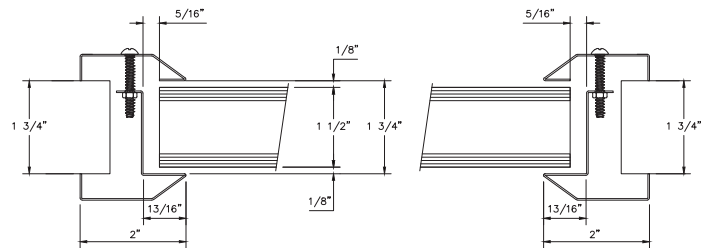

SuperLite II-XL 90